

HellermannTyton

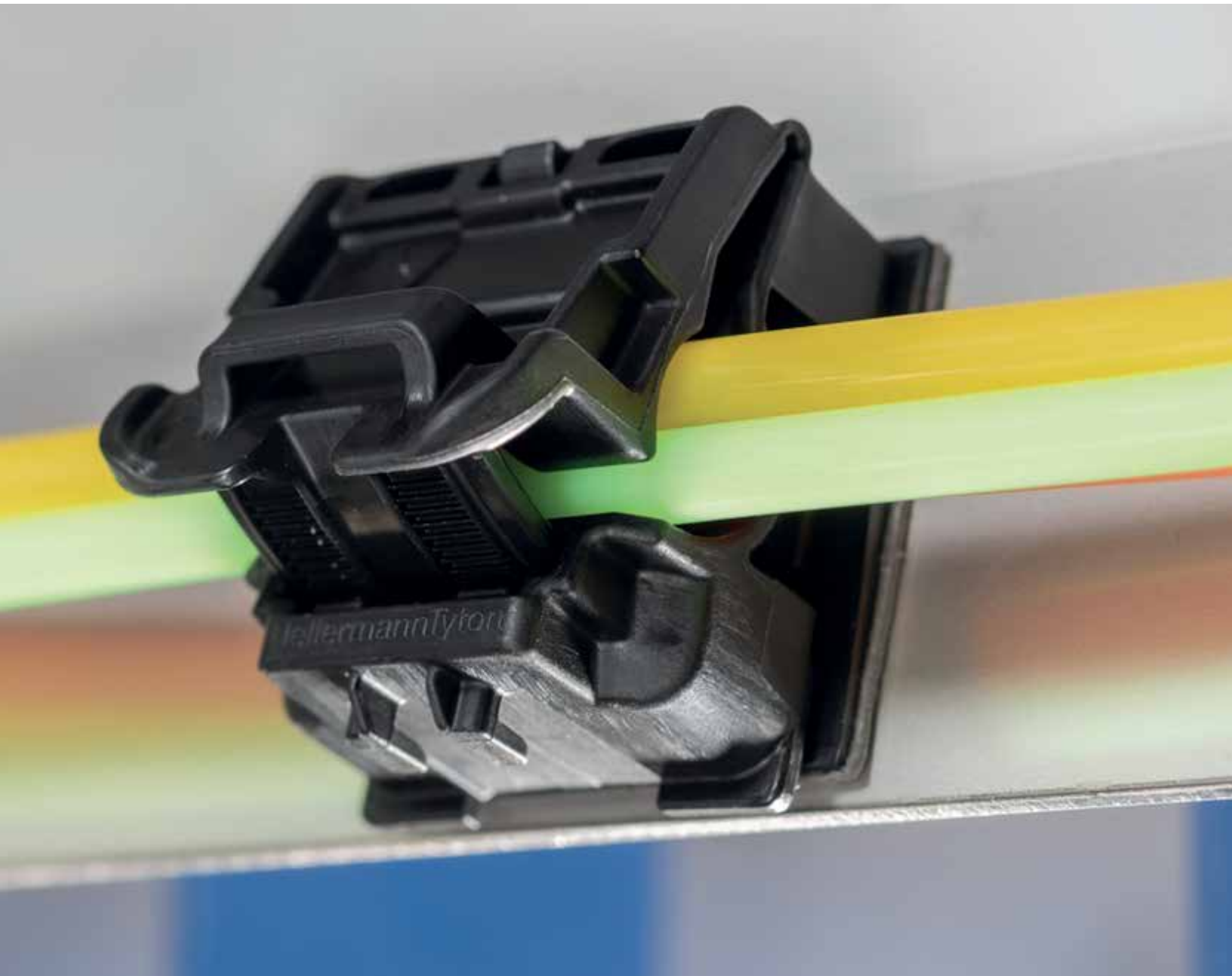

Inline Ratchet Clamps

Rugged Bundle Management for Heavy Duty Applications

MADE FOR REAL 

Rugged bundle management for heavy duty applications



Welcome to the one-of-a-kind Inline Ratchet Clamps product family

Ratchet Clamps provide installers and MROs with an innovative wire bundling solution. At the core of the clamp there is an adjustable ratchet clamp mechanism that clicks as it closes around a bundle, providing assurance it perfectly fits the bundle diameter and is locked down.

A release feature allows easy and nondestructive removal of cables simply by using a flat-head screwdriver. That way, the clamp can be reused or serviced without removing it from the mounting surface.

Use this brochure to learn about:

- Multiple sizes and configurations that reduce part count yet provide more bundling and routing flexibility.
- Inline choices to provide multiple attachment options.
- Material specifications that meet any application in any environment.

Bottom line: Inline Ratchet Clamps creatively solves the toughest wire bundling challenges in machine, heavy equipment, automotive, construction and solar installations.



Inline Ratchet P-Clamp Features



Reduce and simplify with multiple options



Oval 7 x 12 mm



Oval 9 x 17 mm



Round 6.5 mm



Round 9 mm



Self-Adhesive



Bolt Mount Ratchet Clamp
Low and High Torque



Stud Mount Ratchet Clamp

The wiring schemes in heavy duty applications become increasingly complex with each passing year. Using a single mounting point, you can combine our Ratchet Clamps to match the number, position and diameters of your wires or bundles. Where an application has few mounting holes available, use a mix of hole-mountable RCs and adhesive base models where extra support is needed.

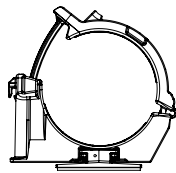

Where no hole exists, or drilling is undesirable, select the Ratchet Clamp with **adhesive mount**. It's a convenient solution you won't find with traditional metal P-clamps.

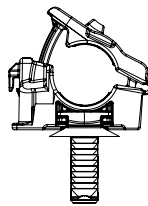

Some of our Inline Ratchet Clamps feature **fir tree mounts**. An all-in-one solution, they can be inserted into new or existing mounting holes with no additional hardware.

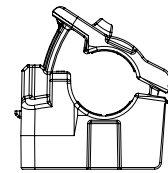

Bolt and Stud Mount Ratchet Clamps are easily attach using a bolt in an existing hole, or to existing studs, eliminating the need for additional hardware.

Multi-part P-clamps are a hassle to use, and keeping a stocked inventory is near impossible. Brackets are an old-fashioned solution, too, adding steps to what should be a simple process. One Ratchet Clamp can consolidate multiple parts, simplify manual processes and significantly reduce labor costs.

Designed to adapt to more applications



Versatile

Working with a mix of wires and cable sizes? Ratchet Clamp will secure a range of cables without changing any other part of your cable routing and management strategy.



Self-mounting

Eliminate the need for a bolt or screw by specifying an Inline RC with fir tree on your project. Choose this oval fir tree to prevent rotation, or select the round fir tree for round holes.



Universal

Name the application – the Ratchet Clamp goes anywhere from over the engine to under the chassis ... from a rail yard to a machine shop ... or from a solar farm in Death Valley to an electrical tower in International Falls, Minnesota.



Contoured clamp interior

The contoured interior helps to position and center cables or bundles as the clamp closes, minimizing pinching and the associated rework caused by damage to wires.



No mounting hole needed

Enjoy the many capabilities of the Ratchet Clamp, even along surfaces that have no predrilled holes. The adhesive base on this Inline RC provides a nondestructive method of getting the job done and saves time in the process.

We engineered the hassle out of using P-clamps



Ease of Use

No more struggling with grommets and multi-piece designs that are difficult to handle. No more unscrewing or prying open the clamp when you need to reposition or change out the bundle. The Ratchet Clamp opens and closes as needed and while firmly fastened to the application surface. Our Inline RC even includes the mount for true, one-handed installation.



One-piece design – one-touch secure

Our one-piece, solid-body design clicks as it closes to let you know it's secure. You'll never have to put a clamp in place and struggle to mount it while holding the pieces together around the bundle.



Effortless clamp release

Ever have to unscrew and remove a metal P-clamp to access the bundle? That's a lot of work. With RC, simply insert a flat blade screwdriver between the locking rails to open it without removing the mounting hardware.



Precision tensioning in an instant

Need to apply an exact amount of force onto your bundle? Insert our Tension Tab and use an EVO® Series hand tool to close the clamp. Tensioning is fully adjustable, and the tool automatically cuts off the excess tab material.



Pre-install to get ahead

Attach Ratchet Clamps along wire harnesses to pre-assemble them before taking the next step. Or, mount the clamps to the work surface first, then bring over the harness. You'll streamline the process and add production line workflow flexibility.

Bundling and Securing

Ratchet Clamps

Inline Ratchet Clamp

Oval Fir Tree Mount - 7 x 12 mm

The Inline Ratchet Clamp family offers versatility when managing wires, cables and hoses. Built-in attachments include round and oval fir trees and adhesive mounts, so no additional hardware is needed for securing to a hole or panel. The robust design and durable materials make it ideal for heavy duty applications, both indoors and out. The adjustable clamp can be closed by hand to the desired diameter. The release feature allows easy and nondestructive removal of cables simply by using a flat-head screwdriver. In this way, the clamp can be reused or serviced without removing it from the mounting surface.

Features and Benefits

- One-piece ratchet closure allows for easy installation during pre- or final assembly.
- Easy release feature simplifies quick adjustments and maintenance.
- Impact modified, heat and UV stabilized PA66 provides long-term durability, indoors and out.
- High-performing oval fir trees ensure anti-rotational routing in existing or stamped oval or rectangular holes with no additional hardware required.



MATERIAL	Polyamide 6.6 high impact modified, heat and UV stabilized (PA66HIRHSUV)
Operating Temperature**	-40°F to +221°F (-40°C to +105°C)
Flammability	UL 94 HB
Color	Black (BK)

RoHS ✓

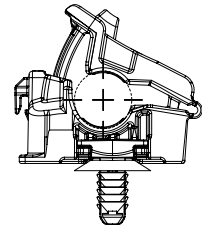
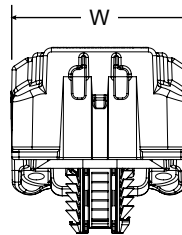

PART NO.	TYPE	Min. Bundle Diameter in. (mm)	Max. Bundle Diameter in. (mm)	Min. Tensile Strength lbs. (N)	Mounting Hole Dia. in. (mm)	Panel Thickness in. (mm)	Fixation Method	Width (W) in. (mm)	Pkg. Qty.
156-02710	IRCAFTOVAL	0.2 (6.1)	0.5 (13.7)	100.0 (445.0)	0.28 x 0.47 (7.0 x 12.0)	0.02 - 0.27 (0.6 - 6.8)	Fir Tree for oval holes	1.4 (34.9)	25
156-02618		0.2 (6.1)	0.5 (13.7)	100.0 (445.0)	0.28 x 0.47 (7.0 x 12.0)	0.02 - 0.27 (0.6 - 6.8)	Fir Tree for oval holes	1.4 (34.9)	250
156-02711	IRCBFTOVAL	0.5 (12.7)	0.8 (19.6)	100.0 (445.0)	0.28 x 0.47 (7.0 x 12.0)	0.02 - 0.27 (0.6 - 6.8)	Fir Tree for oval holes	1.4 (34.9)	25
156-02628		0.5 (12.7)	0.8 (19.6)	100.0 (445.0)	0.28 x 0.47 (7.0 x 12.0)	0.02 - 0.27 (0.6 - 6.8)	Fir Tree for oval holes	1.4 (34.9)	250
156-02712	IRCCFTOVAL	0.8 (19.3)	1.4 (36.0)	100.0 (445.0)	0.28 x 0.47 (7.0 x 12.0)	0.02 - 0.27 (0.6 - 6.8)	Fir Tree for oval holes	1.4 (34.9)	25
156-02638		0.8 (19.3)	1.4 (36.0)	100.0 (445.0)	0.28 x 0.47 (7.0 x 12.0)	0.02 - 0.27 (0.6 - 6.8)	Fir Tree for oval holes	1.4 (34.9)	250
156-02713	IRCDFTOVAL	1.4 (36.0)	2.0 (50.8)	100.0 (445.0)	0.28 x 0.47 (7.0 x 12.0)	0.02 - 0.27 (0.6 - 6.8)	Fir Tree for oval holes	1.4 (34.9)	25
156-02648		1.4 (36.0)	2.0 (50.8)	100.0 (445.0)	0.28 x 0.47 (7.0 x 12.0)	0.02 - 0.27 (0.6 - 6.8)	Fir Tree for oval holes	1.4 (34.9)	200

Dimensions are approximate and subject to technical changes. Use Part No. for ordering and Type for specification purposes.

**Ratchet Clamps have been tested to -40°F to +257°F (-40°C to +125°C)

Inline Ratchet Clamp

Oval Fir Tree Mount - 9 x 17 mm

The Inline Ratchet Clamp family offers versatility when managing wires, cables and hoses. Built-in attachments include round and oval fir trees and adhesive mounts, so no additional hardware is needed for securing to a hole or panel. The robust design and durable materials make it ideal for heavy duty applications, both indoors and out. The adjustable clamp can be closed by hand to the desired diameter. The release feature allows easy and nondestructive removal of cables simply by using a flat-head screwdriver. In this way, the clamp can be reused or serviced without removing it from the mounting surface.

Features and Benefits

- One-piece ratchet closure allows for easy installation during pre- or final assembly.
- Easy release feature simplifies quick adjustments and maintenance.
- Impact modified, heat and UV stabilized PA66 provides long-term durability, indoors and out.
- High-performing oval fir trees ensure anti-rotational routing in existing or stamped oval or rectangular holes with no additional hardware required.



MATERIAL	Polyamide 6.6 high impact modified, heat and UV stabilized (PA66HIRHSUV)
Operating Temperature**	-40°F to +221°F (-40°C to +105°C)
Flammability	UL 94 HB
Color	Black (BK)

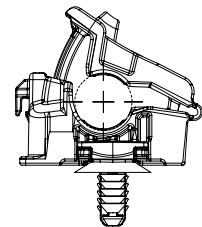
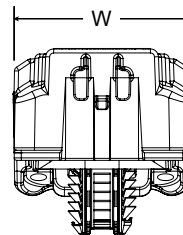

PART NO.	TYPE	Min. Bundle Diameter in. (mm)	Max. Bundle Diameter in. (mm)	Min. Tensile Strength lbs. (N)	Mounting Hole Dia. in. (mm)	Panel Thickness in. (mm)	Fixation Method	Width (W) in. (mm)	Pkg. Qty.
156-02718	IRCAFT9X17	0.2 (6.1)	0.5 (13.7)	100.0 (445.0)	0.35 x 0.67 (9.0 x 17.0)	0.02 - 0.27 (0.6 - 6.8)	Fir Tree for oval holes	1.4 (34.9)	25
156-02622		0.2 (6.1)	0.5 (13.7)	100.0 (445.0)	0.35 x 0.67 (9.0 x 17.0)	0.02 - 0.27 (0.6 - 6.8)	Fir Tree for oval holes	1.4 (34.9)	250
156-02719	IRCBFT9X17	0.5 (12.7)	0.8 (19.6)	100.0 (445.0)	0.35 x 0.67 (9.0 x 17.0)	0.02 - 0.27 (0.6 - 6.8)	Fir Tree for oval holes	1.4 (34.9)	25
156-02632		0.5 (12.7)	0.8 (19.6)	100.0 (445.0)	0.35 x 0.67 (9.0 x 17.0)	0.02 - 0.27 (0.6 - 6.8)	Fir Tree for oval holes	1.4 (34.9)	250
156-02720	IRCCFT9X17	0.8 (19.3)	1.4 (36.0)	100.0 (445.0)	0.35 x 0.67 (9.0 x 17.0)	0.02 - 0.27 (0.6 - 6.8)	Fir Tree for oval holes	1.4 (34.9)	25
156-02642		0.8 (19.3)	1.4 (36.0)	100.0 (445.0)	0.35 x 0.67 (9.0 x 17.0)	0.02 - 0.27 (0.6 - 6.8)	Fir Tree for oval holes	1.4 (34.9)	250
156-02721	IRCDFT9X17	1.4 (36.0)	2.0 (50.8)	100.0 (445.0)	0.35 x 0.67 (9.0 x 17.0)	0.02 - 0.27 (0.6 - 6.8)	Fir Tree for oval holes	1.4 (34.9)	25
156-02652		1.4 (36.0)	2.0 (50.8)	100.0 (445.0)	0.35 x 0.67 (9.0 x 17.0)	0.02 - 0.27 (0.6 - 6.8)	Fir Tree for oval holes	1.4 (34.9)	200

Dimensions are approximate and subject to technical changes. Use Part No. for ordering and Type for specification purposes.

**Ratchet Clamps have been tested to -40°F to +257°F (-40°C to +125°C)

Bundling and Securing

Ratchet Clamps

Inline Ratchet Clamp

Round Fir Tree Mount - 6.5 mm

The Inline Ratchet Clamp family offers versatility when managing wires, cables and hoses. Built-in attachments include round and oval fir trees and adhesive mounts, so no additional hardware is needed for securing to a hole or panel. The robust design and durable materials make it ideal for heavy duty applications, both indoors and out. The adjustable clamp can be closed by hand to the desired diameter. The release feature allows easy and nondestructive removal of cables simply by using a flat-head screwdriver. In this way, the clamp can be reused or serviced without removing it from the mounting surface.

Features and Benefits

- One-piece ratchet closure allows for easy installation during pre- or final assembly.
- Easy release feature simplifies quick adjustments and maintenance.
- Impact modified, heat and UV stabilized PA66 provides long-term durability, indoors and out.
- High-performing round fir trees mean no additional fastener is needed for mounting.



MATERIAL	Polyamide 6.6 high impact modified, heat and UV stabilized (PA66HIRHSUV)
Operating Temperature**	-40°F to +221°F (-40°C to +105°C)
Flammability	UL 94 HB
Color	Black (BK)

RoHS ✓

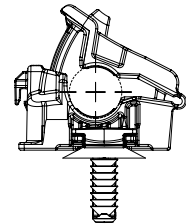
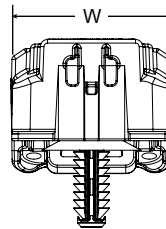

PART NO.	TYPE	Min. Bundle Diameter in. (mm)	Max. Bundle Diameter in. (mm)	Min. Tensile Strength lbs. (N)	Mounting Hole Dia. in. (mm)	Panel Thickness in. (mm)	Fixation Method	Width (W) in. (mm)	Pkg. Qty.
156-02706	IRCAFT6.5LG	0.2 (6.1)	0.5 (13.7)	100.0 (445.0)	0.26 (6.5)	0.02 - 0.35 (0.6 - 9.0)	Fir tree for round holes	1.4 (34.9)	25
156-02616		0.2 (6.1)	0.5 (13.7)	100.0 (445.0)	0.26 (6.5)	0.02 - 0.35 (0.6 - 9.0)	Fir tree for round holes	1.4 (34.9)	250
156-02707	IRCBFT6.5LG	0.5 (12.7)	0.8 (19.6)	100.0 (445.0)	0.26 (6.5)	0.02 - 0.35 (0.6 - 9.0)	Fir tree for round holes	1.4 (34.9)	25
156-02626		0.5 (12.7)	0.8 (19.6)	100.0 (445.0)	0.26 (6.5)	0.02 - 0.35 (0.6 - 9.0)	Fir tree for round holes	1.4 (34.9)	250
156-02708	IRCCFT6.5LG	0.8 (19.3)	1.4 (36.0)	100.0 (445.0)	0.26 (6.5)	0.02 - 0.35 (0.6 - 9.0)	Fir tree for round holes	1.4 (34.9)	25
156-02636		0.8 (19.3)	1.4 (36.0)	100.0 (445.0)	0.26 (6.5)	0.02 - 0.35 (0.6 - 9.0)	Fir tree for round holes	1.4 (34.9)	250
156-02709	IRCDFT6.5LG	1.4 (36.0)	2.0 (50.8)	100.0 (445.0)	0.26 (6.5)	0.02 - 0.35 (0.6 - 9.0)	Fir tree for round holes	1.4 (34.9)	25
156-02646		1.4 (36.0)	2.0 (50.8)	100.0 (445.0)	0.26 (6.5)	0.02 - 0.35 (0.6 - 9.0)	Fir tree for round holes	1.4 (34.9)	200

Dimensions are approximate and subject to technical changes. Use Part No. for ordering and Type for specification purposes.
 **Ratchet Clamps have been tested to -40°F to +257°F (-40°C to +125°C)

Inline Ratchet Clamp

Round Fir Tree Mount - 9 mm

The Inline Ratchet Clamp family offers versatility when managing wires, cables and hoses. Built-in attachments include round and oval fir trees and adhesive mounts, so no additional hardware is needed for securing to a hole or panel. The robust design and durable materials make it ideal for heavy duty applications, both indoors and out. The adjustable clamp can be closed by hand to the desired diameter. The release feature allows easy and nondestructive removal of cables simply by using a flat-head screwdriver. In this way, the clamp can be reused or serviced without removing it from the mounting surface.

Features and Benefits

- One-piece ratchet closure allows for easy installation during pre- or final assembly.
- Easy release feature simplifies quick adjustments and maintenance.
- Impact modified, heat and UV stabilized PA66 provides long-term durability, indoors and out.
- High-performing round fir trees mean no additional fastener is needed for mounting.



MATERIAL	Polyamide 6.6 high impact modified, heat and UV stabilized (PA66HIRHSUV)
Operating Temperature**	-40°F to +221°F (-40°C to +105°C)
Flammability	UL 94 HB
Color	Black (BK)

RoHS ✓

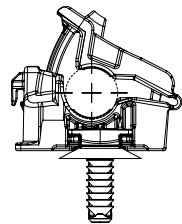
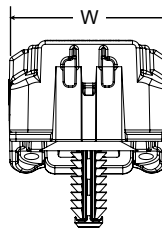

PART NO.	TYPE	Min. Bundle Diameter in. (mm)	Max. Bundle Diameter in. (mm)	Min. Tensile Strength lbs. (N)	Mounting Hole Dia. in. (mm)	Panel Thickness in. (mm)	Fixation Method	Width (W) in. (mm)	Pkg. Qty.
156-02714	IRCAFT9LG	0.2 (6.1)	0.5 (13.7)	100.0 (445.0)	0.35 (9.0)	0.02 - 0.50 (0.6 - 12.7)	Fir tree for round holes	1.4 (34.9)	25
156-02620		0.2 (6.1)	0.5 (13.7)	100.0 (445.0)	0.35 (9.0)	0.02 - 0.50 (0.6 - 12.7)	Fir tree for round holes	1.4 (34.9)	250
156-02715	IRCBFT9LG	0.5 (12.7)	0.8 (19.6)	100.0 (445.0)	0.35 (9.0)	0.02 - 0.50 (0.6 - 12.7)	Fir tree for round holes	1.4 (34.9)	25
156-02630		0.5 (12.7)	0.8 (19.6)	100.0 (445.0)	0.35 (9.0)	0.02 - 0.50 (0.6 - 12.7)	Fir tree for round holes	1.4 (34.9)	250
156-02716	IRCCFT9LG	0.8 (19.3)	1.4 (36.0)	100.0 (445.0)	0.35 (9.0)	0.02 - 0.50 (0.6 - 12.7)	Fir tree for round holes	1.4 (34.9)	25
156-02640		0.8 (19.3)	1.4 (36.0)	100.0 (445.0)	0.35 (9.0)	0.02 - 0.50 (0.6 - 12.7)	Fir tree for round holes	1.4 (34.9)	250
156-02717	IRCDFT9LG	1.4 (36.0)	2.0 (50.8)	100.0 (445.0)	0.35 (9.0)	0.02 - 0.50 (0.6 - 12.7)	Fir tree for round holes	1.4 (34.9)	25
156-02650		1.4 (36.0)	2.0 (50.8)	100.0 (445.0)	0.35 (9.0)	0.02 - 0.50 (0.6 - 12.7)	Fir tree for round holes	1.4 (34.9)	200

Dimensions are approximate and subject to technical changes. Use Part No. for ordering and Type for specification purposes.
 **Ratchet Clamps have been tested to -40°F to +257°F (-40°C to +125°C)

Bundling and Securing

Ratchet Clamps

Inline Ratchet Clamp

Adhesive Mount

The Inline Ratchet Clamp family offers versatility when managing wires, cables and hoses. Built-in attachments include round and oval fir trees and adhesive mounts, so no additional hardware is needed for securing to a hole or panel. The robust design and durable materials make it ideal for heavy duty applications, both indoors and out. The adjustable clamp can be closed by hand to the desired diameter. The release feature allows easy and nondestructive removal of cables simply by using a flat-head screwdriver. In this way, the clamp can be reused or serviced without removing it from the mounting surface.

Features and Benefits

- One-piece ratchet closure allows for easy installation during pre- or final assembly.
- Easy release feature simplifies quick adjustments and maintenance.
- Impact modified, heat and UV stabilized PA66 provides long-term durability, indoors and out.
- 3M™ VHB™ adhesive on base creates an incredible bond with mounting surface.



MATERIAL	Polyamide 6.6 high impact modified, heat and UV stabilized (PA66HIRHSUV)
Operating Temperature**	-40°F to +221°F (-40°C to +105°C)
Flammability	UL 94 HB
Color	Black (BK)

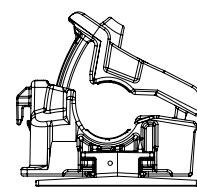
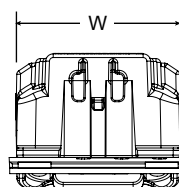

PART NO.	TYPE	Min. Bundle Diameter in. (mm)	Max. Bundle Diameter in. (mm)	Min. Tensile Strength lbs. (N)	Fixation Method	Width (W) in. (mm)	Adhesive	Pkg. Qty.
156-02722	IRCAMB5A	0.2 (6.1)	0.5 (13.7)	100.0 (445.0)	Adhesive	1.4 (34.9)	Acrylic	25
156-02624		0.2 (6.1)	0.5 (13.7)	100.0 (445.0)	Adhesive	1.4 (34.9)	Acrylic	250
156-02723	IRCBMB5A	0.5 (12.7)	0.8 (19.6)	100.0 (445.0)	Adhesive	1.4 (34.9)	Acrylic	25
156-02634		0.5 (12.7)	0.8 (19.6)	100.0 (445.0)	Adhesive	1.4 (34.9)	Acrylic	250
156-02724	IRCCMB5A	0.8 (19.3)	1.4 (36.0)	100.0 (445.0)	Adhesive	1.4 (34.9)	Acrylic	25
156-02644		0.8 (19.3)	1.4 (36.0)	100.0 (445.0)	Adhesive	1.4 (34.9)	Acrylic	250
156-02725	IRCDMB5A	1.4 (36.0)	2.0 (50.8)	100.0 (445.0)	Adhesive	1.4 (34.9)	Acrylic	25
156-02654		1.4 (36.0)	2.0 (51.0)	100.0 (445.0)	Adhesive	1.4 (34.9)	Acrylic	200

Dimensions are approximate and subject to technical changes. Use Part No. for ordering and Type for specification purposes.

3M and VHB are trademarks of 3M Company. *This product meets UL standards. **Ratchet Clamps have been tested to -40°F to +257°F (-40°C to +125°C)

Inline Ratchet Clamps

Stud Mount Ratchet Clamps

The Stud Mount Ratchet Clamp offers versatility when managing wires, cables and hoses. It is specially designed for locations with space constraints or where offset mounting options are not ideal. Easily attaches to existing studs or bolts without the need for additional hardware. The robust design and durable materials make it ideal for heavy duty applications, both indoors and out. The adjustable clamp can be closed by hand to the desired diameter. The release feature allows easy and nondestructive removal or addition of cables simply by inserting a flat-head screwdriver. In this way, the clamp can be reused without removing it from the mounting surface.

Features and Benefits

- Smaller footprint for applications where space is constrained.
- Easily attaches to existing bolts or studs, eliminating the need for additional hardware.
- Cover/stopper inside the clamp prevents stud from touching the cable bundle, minimizing chafing and protecting bundle from damage.
- One-piece ratchet closure design allows for easy installation during pre- or final assembly.
- Clamp interior is designed to guide and center bundles to reduce pinching.



MATERIAL	Polyamide 6.6 high impact modified, heat and UV stabilized (PA66HIRHSUV)
Operating Temperature	-40°F to +221°F (-40°C to +105°C)
Flammability	UL 94 HB
Color	Black (BK)

HF ✓

RoHS ✓

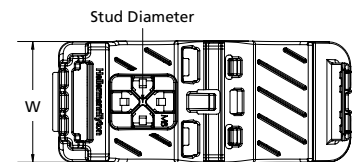
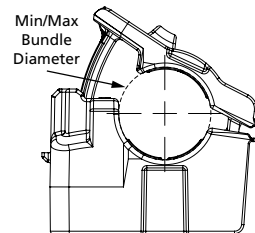

PART NO.	TYPE	Stud Size in. (mm)	Min. Bundle Diameter in. (mm)	Max. Bundle Diameter in. (mm)	Min. Tensile Strength lbs. (N)	Width (W) in. (mm)	Pkg. Qty.
151-03544	CMRCBSMM6	0.236 (6.0)	0.5 (12.7)	0.8 (19.6)	200.0 (889.0)	1.4 (35.1)	150
151-03545	CMRCBSMM8	0.315 (8.0)	0.5 (12.7)	0.8 (19.6)	200.0 (889.0)	1.4 (35.1)	150
151-03546	CMRCBSMM10	0.394 (10.0)	0.5 (12.7)	0.8 (19.6)	200.0 (889.0)	1.4 (35.1)	150
151-03555	CMRCCSMM6	0.236 (6.0)	0.8 (19.3)	1.4 (36.1)	250.0 (1112.0)	1.4 (35.1)	150
151-03556	CMRCCSMM8	0.315 (8.0)	0.8 (19.3)	1.4 (36.1)	250.0 (1112.0)	1.4 (35.1)	150
151-03557	CMRCCSMM10	0.394 (10.0)	0.8 (19.3)	1.4 (36.1)	250.0 (1112.0)	1.4 (35.1)	150
151-03566	CMRCDSMM6	0.236 (6.0)	1.4 (36.1)	2.0 (50.8)	250.0 (1112.0)	1.4 (35.1)	150
151-03567	CMRCDSMM8	0.315 (8.0)	1.4 (36.1)	2.0 (50.8)	250.0 (1112.0)	1.4 (35.1)	150
151-03568	CMRCDSMM10	0.394 (10.0)	1.4 (36.1)	2.0 (50.8)	250.0 (1112.0)	1.4 (35.1)	150

Dimensions are approximate and subject to technical changes. Use Part No. for ordering and Type for specification purposes.

Bundling and Securing

Ratchet Clamps

Inline Ratchet Clamps

Bolt Mount Ratchet Clamp

The Bolt Mount Ratchet Clamp offers versatility when managing conduit, wires, cables and hoses. It is specially designed for locations with space constraints or where offset mounting options are not ideal. Available with a compression limiter for crush resistance in high-torque applications, or in all-plastic for low- to medium-torque applications. The robust design and durable materials make it ideal for heavy duty applications, both indoors and out. The adjustable clamp can be closed by hand to the desired diameter. The release feature allows easy and nondestructive removal or addition of cables simply by inserting a flat-head screwdriver. In this way, the clamp can be reused without removing it from the mounting surface.



Features and Benefits

- Smaller footprint for applications where space is constrained.
- Attach using a bolt in an existing threaded hole, or bolt and nut for a non-threaded hole, for versatile mounting options.
- One-piece ratchet closure allows for fast and easy installation.
- Clamp interior is designed to guide and center bundles to reduce pinching.

MATERIAL	Polyamide 6.6 high impact modified, heat and UV stabilized (PA66HIRHSUV)
Operating Temperature	-40°F to +221°F (-40°C to +105°C)
Flammability	UL 94 HB
Color	Black (BK)

HF ✓

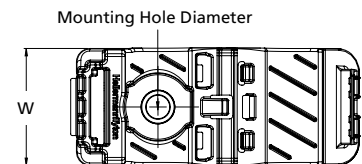
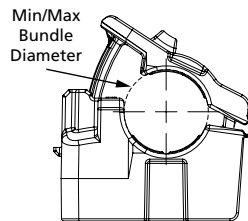

PART NO.	TYPE	Mounting Hole Dia. in. (mm) Mounting Hole Ø	Bolt Size in. (mm)	Min. Bundle Diameter in. (mm)	Max. Bundle Diameter in. (mm)	Min. Tensile Strength lbs. (N)	Width (W) in. (mm)	Pkg. Qty.
Low Torque								
151-03540*	CMRCBLM6	0.248 (6.3)	0.2 (6.0)	0.5 (12.7)	0.8 (19.6)	200.0 (889.0)	1.4 (35.1)	150
151-04005*		0.248 (6.3)	0.2 (6.0)	0.5 (12.7)	0.8 (19.6)	200.0 (889.0)	1.4 (35.1)	25
151-03541*	CMRCBLM8	0.327 (8.3)	0.3 (8.0)	0.5 (12.7)	0.8 (19.6)	200.0 (889.0)	1.4 (35.1)	150
151-04006*		0.327 (8.3)	0.3 (8.0)	0.5 (12.7)	0.8 (19.6)	200.0 (889.0)	1.4 (35.1)	25
151-03550*	CMRCCLM6	0.248 (6.3)	0.2 (6.0)	0.8 (19.3)	1.4 (36.1)	250.0 (1112.0)	1.4 (35.1)	150
151-04007*		0.248 (6.3)	0.2 (6.0)	0.8 (19.3)	1.4 (36.1)	250.0 (1112.0)	1.4 (35.1)	25
151-03551*	CMRCCLM8	0.327 (8.3)	0.3 (8.0)	0.8 (19.3)	1.4 (36.1)	250.0 (1112.0)	1.4 (35.1)	150
151-04008*		0.327 (8.3)	0.3 (8.0)	0.8 (19.3)	1.4 (36.1)	250.0 (1112.0)	1.4 (35.1)	25
151-03552*	CMRCCLM10	0.405 (10.3)	0.4 (10.0)	0.8 (19.3)	1.4 (36.1)	250.0 (1112.0)	1.4 (35.1)	150
151-04009*		0.405 (10.3)	0.4 (10.0)	0.8 (19.3)	1.4 (36.1)	250.0 (1112.0)	1.4 (35.1)	25
151-03561	CMRCCLM6	0.248 (6.3)	0.2 (6.0)	1.4 (36.1)	2.0 (50.8)	250.0 (1112.0)	1.4 (35.1)	150
151-03562	CMRCCLM8	0.327 (8.3)	0.3 (8.0)	1.4 (36.1)	2.0 (50.8)	250.0 (1112.0)	1.4 (35.1)	150
151-03563	CMRCCLM10	0.405 (10.3)	0.4 (10.0)	1.4 (36.1)	2.0 (50.8)	250.0 (1112.0)	1.4 (35.1)	150

Dimensions are approximate and subject to technical changes. Use Part No. for ordering and Type for specification purposes.

*This product meets UL standards. Please go to hellermannntyton.us for specific file numbers.

Inline Ratchet Clamps

Bolt Mount Ratchet Clamp

PART NO.	TYPE	Mounting Hole Dia. in. (mm) Mounting Hole Ø	Bolt Size in. (mm)	Min. Bundle Diameter in. (mm)	Max. Bundle Diameter in. (mm)	Min. Tensile Strength lbs. (N)	Width (W) in. (mm)	Pkg. Qty.
High Torque								
151-03538	CMRCBHM6	0.276 (7.0)	0.2 (6.0)	0.5 (12.7)	0.8 (19.6)	200.0 (889.0)	1.4 (35.1)	150
151-03539	CMRCBHM8	0.354 (9.0)	0.3 (8.0)	0.5 (12.7)	0.8 (19.6)	200.0 (889.0)	1.4 (35.1)	150
151-03547	CMRCCHM6	0.276 (7.0)	0.2 (6.0)	0.8 (19.3)	1.4 (36.1)	250.0 (1112.0)	1.4 (35.1)	150
151-03548	CMRCCHM8	0.354 (9.0)	0.3 (8.0)	0.8 (19.3)	1.4 (36.1)	250.0 (1112.0)	1.4 (35.1)	150
151-03549	CMRCCHM10	0.441 (M10)	0.4 (10.0)	0.8 (19.3)	1.4 (36.1)	250.0 (1112.0)	1.4 (35.1)	150
151-03558	CMRCDHM6	0.276 (7.0)	0.2 (6.0)	1.4 (36.1)	2.0 (50.8)	250.0 (1112.0)	1.4 (35.1)	150
151-03559	CMRCDHM8	0.354 (9.0)	0.3 (8.0)	1.4 (36.1)	2.0 (50.8)	250.0 (1112.0)	1.4 (35.1)	150
151-03560	CMRCDHM10	0.441 (M10)	0.4 (10.0)	1.4 (36.1)	2.0 (50.8)	250.0 (1112.0)	1.4 (35.1)	150

Dimensions are approximate and subject to technical changes. Use Part No. for ordering and Type for specification purposes.

*This product meets UL standards. Please go to hellermann-tyton.us for specific file numbers.



Please note - not all products listed on this page may have this approval. Please see www.HellermannTyton.com for the latest approvals.

Bundling and Securing

Accessories

Inline Ratchet Clamp

Accessories

The Ratchet Clamp family offers optional accessories for different user needs. The Tension Tab enables installers to apply a specific clamp tension when used with EVO® Series hand tools. And Soft Inserts provide an added level of protection for sensitive bundles or high-vibration applications.

Features and Benefits

- Built-in channel on Ratchet Clamp makes using Tension Tabs quick and easy.
- When used with the EVO series hand tool, Tension Tabs make it easy to deliver a precise torque setting to the clamp.
- Soft inserts snap precisely into the Ratchet Clamp for quick, error-proof installation.
- Soft inserts counter the effects of vibration to reduce noise and movement.



MATERIAL	Thermoplastic Elastomer (TPE)
Operating Temperature	-40°F to +194°F (-40°C to +90°C)
Flammability	UL 94 HB
Color	Black (BK)



MATERIAL	Polyamide 6.6 high impact modified, heat and UV stabilized (PA66HIRHSUV)
Operating Temperature	-40°F to +221°F (-40°C to +105°C)
Flammability	UL 94 HB
Color	Black (BK)



PART NO.	TYPE	Description	Pkg. Qty.
151-01530*	RCINSERTA	Ratchet P-Clamp Size A Soft Insert	100
151-01531*	RCINSERTB	Ratchet P-Clamp Size B Soft Insert	100
151-01532*	RCINSERTC	Ratchet P-Clamp Size C Soft Insert	100
151-01533*	RCINSERTD	Ratchet P-Clamp Size D Soft Insert	100
151-01529	RCTT	Ratchet P-Clamp Tension Tab	100

Dimensions are approximate and subject to technical changes. Use Part No. for ordering and Type for specification purposes.

*Note: Using soft inserts will reduce clamp diameter range; please test in application to ensure the proper fit. *This product meets UL standards.*



Please note - not all products listed on this page may have this approval. Please see www.HellermannTyton.com for the latest approvals.

Manual Tools

EVO® Mechanical Hand Tools

HellermannTyton's EVO Series cable tie application tools combine durability, precision and control with unparalleled comfort. The innovative, ergonomic design minimizes the stress on hands and wrists and kickback that occurs with traditional tools, reducing the risk of repetitive motion injuries. EVO tools tension and apply HellermannTyton cable ties and Ratchet P-Clamps.

Features and Benefits

- Use with Tension Tab to tension and apply Ratchet P-Clamps.
- EVO tool models are available for tensioning and cutting 18- to 250-lb cable ties.
- Easy-to-adjust tension knob offers 33 different settings for precise, repeatable applications.
- Advanced ergonomic design minimizes necessary hand force and kickback to reduce repetitive



PART NO.	TYPE	Description	Cable Tie Series	Pkg. Qty.
110-77001	EVO7i	EVO 7i Mechanical Hand Tool, Standard Hand Span 90	T18, T30, T40, T50, T80, IT18, IT50	1
110-77002	EVO7iSP	EVO 7iSP Mechanical Hand Tool, Short Hand Span 80	T18, T30, T40, T50, T80, IT18, IT50	1
110-80002	EVO9	EVO 9 Mechanical Hand Tool, Standard Hand Span	T50, T80, T120, T150, T250, T255, WS	1
110-80003	EVO9SP	EVO 9SP Mechanical Hand Tool, Short Hand Span	T50, T80, T120, T150, T250, T255, WS	1
110-80017	EVO9HT	EVO 9HT High Tension Mechanical Hand Tool	T120, T150, T250, T255, WS	1

Dimensions are approximate and subject to technical changes. Use Part No. for ordering and Type for specification purposes.



HellermannTyton

HellermannTyton srl

Via Visco 3/7

35010 Limena (PD)

Tel.: +39 049 767 870

Fax: +39 049 767 985

Email: info@HellermannTyton.it

www.HellermannTyton.it